



sears
property, clear & simple

3 Bedroom Semi-Detached
Capercaillie Close, Jennett's Park,
Bracknell Berkshire RG12 8AX

Price £400,000

Freehold



scan to view full details



**** MASTER BEDROOM SUITE **** This three bedroom Semi-Detached townhouse is located within the popular Jennett's Park development and is walking distance to local parks and shops. The ground floor comprises of the kitchen, w/c and spacious rear aspect living/dining which benefits from being dual aspect.

helping you get a move on!

about the property...

**** MASTER BEDROOM SUITE **** This three bedroom Semi-Detached townhouse is located within the popular Jennett`s Park development and is walking distance to local parks and shops. The ground floor comprises of the kitchen, w/c and spacious rear aspect living/dining area which benefits from being dual aspect. There are two further bedrooms to the first floor which are both of generous proportion and share use of the family bathroom. Spreading across the majority of the top floor is the master bedroom which benefits from fitted wardrobes, an en-suite shower room and a separate bedroom/study/dressing room. Outside the rear garden is mainly laid to lawn with rear access to the allocated parking. There is also a visitors parking and plenty of on street parking available.

Entrance -

Stairs rising to first floor, doors to all rooms, radiator.

Living Room - 15'5" (4.7m) x 14'8" (4.47m)

Rear elevation double glazed window, rear elevation double glazed double doors to garden, under stairs storage cupboard, TV point, BT point, radiator.

Downstairs Cloakroom -

Front elevation double glazed frosted window, low level WC, pedestal hand wash basin, wood effect flooring, radiator.

Kitchen - 10'8" (3.25m) x 8'2" (2.49m)

Front elevation double glazed window, a range of eye and base level units with rolled edge worksurfaces, stainless steel sink and drainer, integrated oven with four ring hob and extractor fan over, space for dishwasher, space for washing machine, space for fridge/freezer, wood effect flooring, part tiled walls, radiator.

First Floor Landing -

Doors to all rooms, airing cupboard, radiator.

Bedroom Two - 15'5" (4.7m) x 9'6" (2.9m)

Rear elevation double glazed window, radiator.

Bedroom Three - 15'5" (4.7m) x 9'8" (2.95m)

Front elevation double glazed window, radiator.

Bathroom -

Side elevation double glazed frosted window, low level WC, pedestal sink with mixer tap, panel enclosed bath with mixer tap and shower attachment over, part tiled walls, wood flooring, heated towel rail.

Second Floor Landing -

Door to master bedroom.

Master Bedroom - 13'2" (4.01m) x 16'2" (4.93m)

Front elevation double glazed window, side elevation double glazed window, double built in wardrobe with hanging space and shelving, built in storage cupboard, TV point, door to En-Suite.

En-Suite -

Rear elevation double glazed frosted window, double width shower cubicle with power shower attachment, low level WC, pedestal hand wash basin, wood flooring, heated towel rail.

Bedroom Four - 8'8" (2.64m) x 9'2" (2.79m)

Rear elevation double glazed window, radiator.

Outside -

To the Front -

Courtesy path to front door.

To the Rear -

Mainly laid to lawn private rear garden with patio area and rear access.

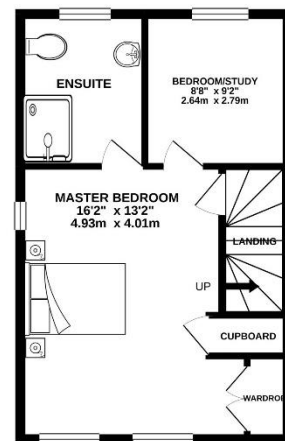
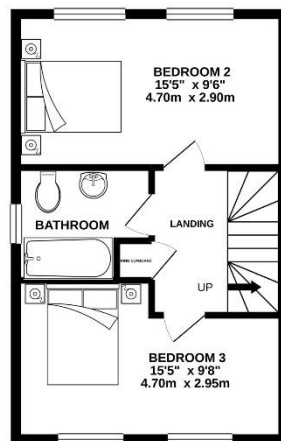
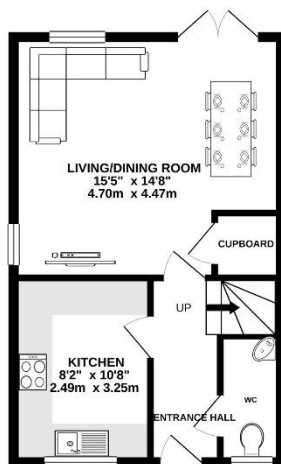

PLEASE NOTE WE HAVE NOT TESTED ANY APPARATUS, FIXTURES, FITTINGS, OR SERVICES. INTERESTED PARTIES MUST UNDERTAKE THEIR OWN INVESTIGATION INTO THE WORKING ORDER OF THESE ITEMS. ALL MEASUREMENTS ARE APPROXIMATE AND PHOTOGRAPHS PROVIDED FOR GUIDANCE ONLY.

we're here to help if you've any questions about this property...

01344 481111  **12 High Street, Bracknell, Berkshire RG12 1LL**

 **searsproperty.co.uk**

 **hello@searsproperty.co.uk**

 **find sears property on facebook**

 **twitter.com/searsproperty**

 **rightmove.co.uk**

 **PrimeLocation.com**

 **Zoopla.co.uk**