



**sears**  
property, clear & simple

2 Bedroom Terrace  
Axbridge, Bracknell,  
Berkshire, RG12 0XB

Price £310,000

Freehold



*scan to view full details*



**\*\* A STUNNINGLY PRESENTED HOME WITH TWO DOUBLE BEDROOMS \*\***

Situated within the popular area of Forest Park is this well presented two double bedroom home. The accommodation to the ground floor comprises 14ft living/dining room and a re-fitted kitchen with integrated appliances

*helping you get a move on!*

## about the property...

**\*\* A STUNNINGLY PRESENTED HOME WITH TWO DOUBLE BEDROOMS \*\*** Situated within the popular area of Forest Park is this well presented two double bedroom home. The accommodation to the ground floor comprises 14ft living/dining room and a re-fitted kitchen with integrated appliances while to the first floor there are two double bedrooms and a re-fitted bathroom. Further benefits include allocated parking for two vehicles, UPVC double glazing and an enclosed low maintenance rear garden. The property has excellent transport links via both M3 and M4 motorways and Martins Heron mainline train station while also have local amenities within walking distance.

### Entrance -

Doors to all rooms, stairs rising to first floor, storage cupboard, wood effect flooring, radiator.

### Living Room - 14'6" (4.42m) x 12'4" (3.76m)

Rear elevation double glazed French doors, TV point, BT point, wood effect flooring, radiator.

### Kitchen - 9'10" (3m) x 6'4" (1.93m)

Front elevation double glazed window, a range of eye and base level units with rolled edge work surfaces, integrated oven with four ring hob and extractor fan over, one and a half bowl stainless steel sink and drainer with mixer tap, integrated fridge/freezer, space for washing machine, space for dishwasher, tiled flooring.

### First Floor Landing -

Doors to all rooms, loft hatch.

### Bedroom One - 12'3" (3.73m) x 11'10" (3.61m)

Two front elevation double glazed windows, storage cupboard, radiator.

### Bedroom Two - 12'4" (3.76m) x 7'11" (2.41m)

Rear elevation double glazed window, radiator.

### Bathroom -

Low level WC, wall mounted sink with mixer tap, panel enclosed bath with mixer tap and shower attachment over, part tiled walls, tiled flooring, heated towel rail.

### Outside -

#### To the Front -

Laid to shingle with courtesy path to front door.

#### To the Rear -

An enclosed rear garden laid to mainly to synthetic grass with areas laid to patio and decking, flower bed border and gated rear access.

### Parking -

Allocated parking for two vehicles.

GROUND FLOOR

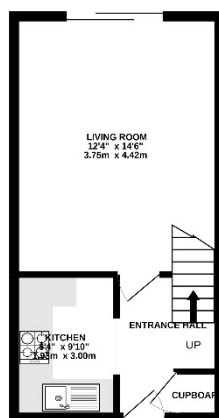

1ST FLOOR

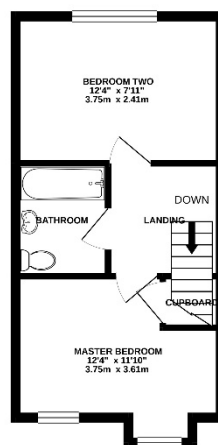

MARKING 10/11/14 (2/20)

**PLEASE NOTE** WE HAVE NOT TESTED ANY APPARATUS, FIXTURES, FITTINGS, OR SERVICES. INTERESTED PARTIES MUST UNDERTAKE THEIR OWN INVESTIGATION INTO THE WORKING ORDER OF THESE ITEMS. ALL MEASUREMENTS ARE APPROXIMATE AND PHOTOGRAPHS PROVIDED FOR GUIDANCE ONLY.

*we're here to help if you've any questions about this property...*

**01344 481111**  **12 High Street, Bracknell, Berkshire RG12 1LL**

 **searsproperty.co.uk**

 **hello@searsproperty.co.uk**

 **find sears property on facebook**

 **twitter.com/searsproperty**

 **rightmove.co.uk**

 **PrimeLocation.com**

 **Zoopla.co.uk**